



**Edward
River**
COUNCIL

Date: Thursday, 27 June 2019
Time: 9.00am
Location: Council Chamber 180 Cressy Street
Deniliquin

BUSINESS PAPER

Supplementary Reports

Ordinary Council Meeting

27 June 2019

Adam McSwain
General Manager

Order Of Business

11	Reports from Officers.....	3
11.1	Drought Communities Programme	3

11 REPORTS FROM OFFICERS**11.1 DROUGHT COMMUNITIES PROGRAMME****Author:** Mark Dalzell, Manager Engineering Assets**Authoriser:** Oliver McNulty, Director Infrastructure**RECOMMENDATION**

That Council approve the submission to the Department of Infrastructure, Regional Development and Cities under the Drought Communities Programme for the following projects:

- Drought Support Officer;
- Tourism Marketing Program;
- CBD Painting Program;
- Town Entrance – Crispe Street;
- Town Entrance – Davidson Street;
- Road Upgrades – Harfleur Street and Wyatt Street; and
- Booroorban Heavy Vehicle Layby.

BACKGROUND

The Federal Government, through the Department of Infrastructure, Regional Development and Cities, has advertised for submissions to the Drought Communities Programme. This programme aims to support communities in the most drought-affected regions of Australia.

The funding amount available to Edward River Council is \$1M, with all funds to be expended by 31 December 2019. Applications for the programme close on 30 June 2019.

ISSUE/DISCUSSION

At its 4 April 2019 workshop, Council discussed the Drought Communities Programme. These discussions included a list of projects that meet the funding guidelines. From the meeting, Council staff have further investigated the following list of projects:

PROJECT	DESCRIPTION	ESTIMATED COST
Drought Support Officer	Recruitment of a Drought Support Officer for a 6 month period.	\$100,000
Tourism Marketing Program	Promote Deniliquin and the Edward River region as a tourism destination to increase domestic day and domestic overnight visitation.	\$50,000
CBD Painting Program	Implementing a dollar-for-dollar revitalisation program in the Deniliquin CBD area, which aims to enhance the appearance shop fronts and signage.	\$100,000
Town Entrance – Crispe Street	Relocation of the 'Deniliquin' arch sign to Crispe Street and associated works.	\$200,000
Town Entrance – Davidson Street	Removal of the existing tennis club building and reinstatement of site.	\$100,000

Road Upgrades – Harfleur and Wyatt Streets	Sealing of sections of Harfleur Street and Wyatt Street.	\$250,000
Booroorban Heavy Vehicle Layby	Construction of a heavy vehicle stopping area along the Cobb Highway.	\$200,000
Total		\$1,000,000

Drought Support Officer

A Drought Support Officer shall be employed on a part time basis for six months. The officer shall be responsible for the management of the Drought Communities Programme as well as providing assistance to the community in accordance with the Drought Communities Programme.

A portion of these funds will be allocated to wages, and the remaining amount will be used to implement community event and industry support initiatives.

Tourism Marketing Program

The tourism marketing program will promote Deniliquin and the Edward River region as a tourism destination, with the aim to increase domestic day and domestic overnight visitation

The \$50,000 of funds will be used in the wider Visit Deni annual marketing campaign. The 2019/2020 program will promote Deniliquin to domestic visitors, purchase promotional material and increase the awareness of the Visit Deni brand.

CBD Painting Programme

Implementing a revitalisation program in the Deniliquin CBD area, which aims to enhance the appearance shop fronts and signage.

The program will be delivered on a dollar-for-dollar basis, allowing businesses the opportunity to revitalise their shopfronts and signage.

Town Entrance – Crispe Street

This work involves the relocation of the existing “Deniliquin’ arch sign from the Cobb Highway to a location near the intersection of the Cobb Highway and Crispe Street. This is in line with the outcomes and objectives of the Deniliquin Master Plan. A copy of the concept for the project, as shown in the Master Plan, is attached to this report.

Works shall include:

- Preparation of the site near the intersection of Crispe Street and the Cobb Highway;
- Relocation of the existing sign;
- Installation of a power supply and lighting to the site;
- Landscaping and trees; and
- Installation of irrigation to the site and parts of the Lions Park area.

These works shall be undertaken by contractors.

Town Entrance – Davidson Street

This project involves the removal of the North Deniliquin Tennis Courts, including buildings and court area, and reinstatement of the site to allow further beautification work in the future. The works shall include some landscaping and associated works.

Due to the nature of the existing buildings, including potential sources of asbestos, works shall be carried out by suitably qualified contractors in accordance with all relevant regulations.

Road Upgrades – Harfleur and Wyatt Streets

This project involves the sealing of sections of Harfleur and Wyatt Streets as noted in the table below:

DESCRIPTION	PROPOSED WORKS	ESTIMATED COST
Harfleur Street, between Burton Street and Wyatt Street	Seal section road 185m long x 6m wide, including the re-construction of 8m wide pavement	\$90,000
Harfleur Street, between Blackett Street and the boat ramp	Seal section road 320m long x 4m wide, including the re-construction of 6m wide pavement	\$60,000
Wyatt Street, between Harfleur Street and Henry Street	Seal section road 200m long x 4m wide, including the re-construction of 6m wide pavement	\$100,000

The estimates for this project have been based on the following:

- the recently completed section of seal along Sloane Street for the section of Harfleur Street down to the boat ramp; and
- the recently completed Russell Street and Butler Street projects for the section of Harfleur Street between Burton Street and Wyatt Street and the section of Wyatt Street between Harfleur Street and Henry Street.

Under the terms of the funding programme, this work shall need to be done by private contractors, rather than Council's operational staff.

Boooroban Heavy Vehicle Layby

This project involves the construction of a heavy vehicle layby area along the Cobb Highway at Boooroban. It is noted that a concept plan for the heavy vehicle layby area has previously been completed. A copy of this plan is attached to this report.

Works shall include:

- Obtaining the relevant approvals from Roads and Maritime Services (RMS), as Cobb Highway is classified as a state highway;
- Construct a gravel hardstand area with an approximate area of 1,600 sq.m. Due to the existing road levels and natural surface levels, the average depth of fill for the hardstand area is 600mm;
- Relocate existing open drains around the newly constructed layby area; and
- Install signage relating to the heavy vehicle layby area.

Council staff have contacted RMS regarding approval for the work. RMS officers have noted their in-principle support for the project, however, have stated that RMS are not able to provide any funding for the project.

Project Management

All the projects in the Drought Communities Programme shall be managed by the Drought Support Officer. Projects involving the construction of assets, or are considered in nature to be capital works, shall be delivered by Council's Project Management team, with the Major Projects Co-

ordinator responsible for liaising with the Drought Support Officer regarding the status of the projects.

Project management shall include the preparation of project plans for all the project and regular reporting against the milestones and objectives stated in the project plans.

STRATEGIC IMPLICATIONS

The projects highlighted in the Drought Communities Programme align with the following strategies adopted by Council:

1. Deniliquin Open Space Strategy 2018
2. Edward River Council Open Space Strategy 2018
3. Edward River Council Community Strategic Plan 2030
4. Edward River Council Economic Development Strategy 2018 - 2021

COMMUNITY STRATEGIC PLAN

This programme meets the following outcomes and targets from the Community Strategic Plan:

- Outcome 1.3: Our community and public spaces are accessible and inclusive and reflect our history, heritage and culture;
- Outcome 2.2: We develop our key assets to enhance agriculture, boost tourism and support existing business;
- Outcome 4.1: Our built environment is managed, maintained and improved.

FINANCIAL IMPLICATIONS

All projects shall be funded under the Drought Communities Programme in line with Department of Infrastructure, Regional Development and Cities guidelines.

LEGISLATIVE IMPLICATIONS

Nil.

ATTACHMENTS

1. **Boorooban Heavy Vehicle Layby Area**
2. **Town Entrance - Crispe Street**

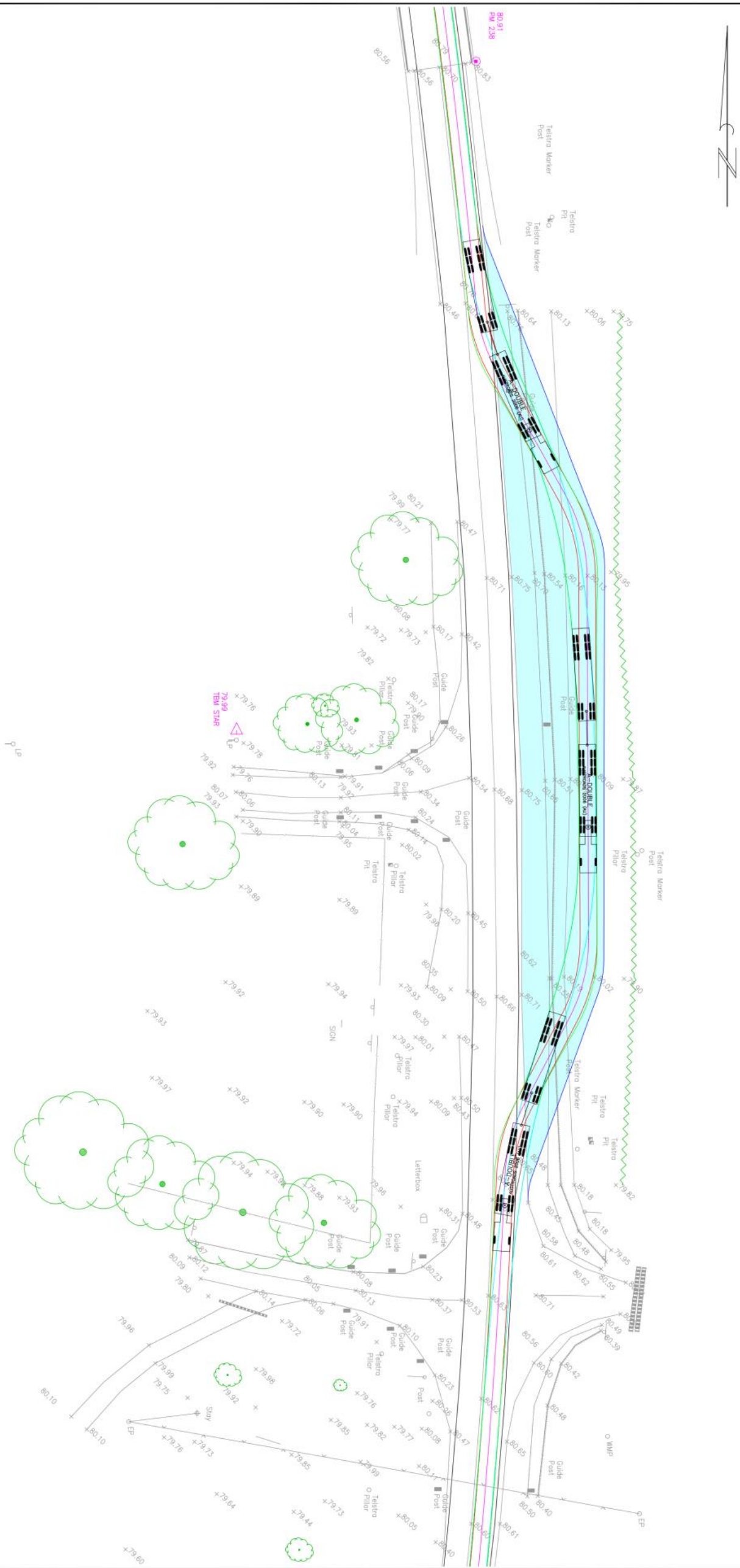

EAST SIDE PARKING BAY - SOUTH BOUND TRAFFIC

NOTE: PLANRIGHT MUST BE GIVEN AT LEAST 5 DAYS NOTICE PRIOR TO CONSTRUCTION COMMENCING

PRELIMINARY PLAN
For discussion purposes only

<p>DISCLAIMER</p> <p>Notwithstanding any description contained in the Plans or Specifications, the Client shall be responsible for the accuracy of the information provided and the location and extent of the proposed works and the physical and legal conditions under which the works will be carried out, including access, easements, rights of way, and any other matters that may affect the construction of the works.</p>																
<p>WARNING</p> <p>BEWARE OF UNDERGROUND SERVICES</p> <p>The location of underground services, where shown, are approximate only. All utilities must be located prior to construction of all underground services.</p>																
<p>RELEASE</p> <table border="1"> <thead> <tr> <th>No.</th> <th>DATE</th> <th>DESCRIPTION</th> </tr> </thead> <tbody> <tr> <td> </td> <td> </td> <td> </td> </tr> <tr> <td> </td> <td> </td> <td> </td> </tr> <tr> <td> </td> <td> </td> <td> </td> </tr> <tr> <td> </td> <td> </td> <td> </td> </tr> </tbody> </table>		No.	DATE	DESCRIPTION												
No.	DATE	DESCRIPTION														
<p>SCALE:</p> <p>1:300 (A1) 1:24</p> <p>0m 12 18 24</p> <p>VER: N/A</p> <p>SCALE: 1:300 (A1) 1:24</p>																
<p>DATE:</p> <p>B.M. No.: B.M.E.:</p> <p>DATE: A.H.D. Oct '15</p> <p>SURVEYED: Planright</p> <p>DESIGNED: CJP Dec '15</p> <p>DRAWN: CJP</p> <p>CHECKED: CJP</p> <p>ORIGINAL SHEET SIZE: A1</p>																
<p>CLIENT:</p> <p>Conargo Shire Road Projects Booroorban Truck Stop Booroorban</p> <p>LAYOUT PLAN</p> <p>PROJECT: 27/01/2016</p>																
<p>IDEAS INTO ACTION</p> <p>PLANRIGHT</p> <p>Civil Engineers, Irrigation Designers, Licensed Surveyors, 139 Hogan Street, TATURA 248 Sydney St, KILMORE 21 Nish Street, ECHUCA Email: results@planright.com.au</p> <p>PH. 03 57822358 PH. 03 54821699</p> <p>THIS PLAN PREPARED USING AN ISO 9001 CERTIFIED QUALITY ASSURED SYSTEM</p>																

2.3 TYPICAL ROAD SIGNAGE (CRISPE STREET / COBB HIGHWAY)

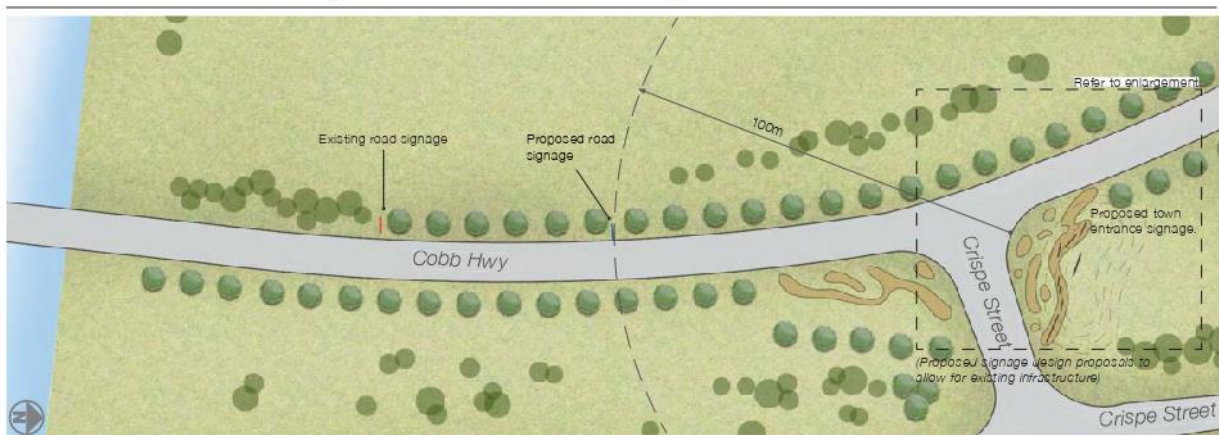

The Crispe Street / Cobb Highway intersection is an example of improving the gateway into Deniliquin for traveler from the south from Moama, Echuca and further afield Melbourne.

The proposed gateway will serve to entice visitors to travel through Deniliquin and possibly stop as well as welcome home residents.

Signage will serve to direct local and tourist traffic via Deniliquin whilst informing heavy vehicles to utilize the Cobb Highway bypass.

Key design elements include:

- The redesigned gateway provides an opportunity to improve the traffic conflict by develop clear way finding to direct heavy truck and tourist/local traffic separately.

- Along the roads leading from the gateway to the CBD there is opportunity for significant tree planting within the road corridor

- Note: (Subject to RMC requirements)



Existing road signage

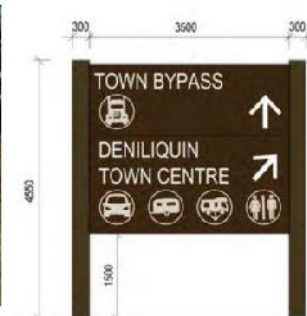

Proposed road signage to direct heavy truck and tourist/local traffic separately

(Subject to RMC requirements)

Fig 6 Deniliquin Masterplan | Fox Edward River Council

2.4 TOWN GATEWAY (CRISPE STREET - SOUTH ENTRANCE)

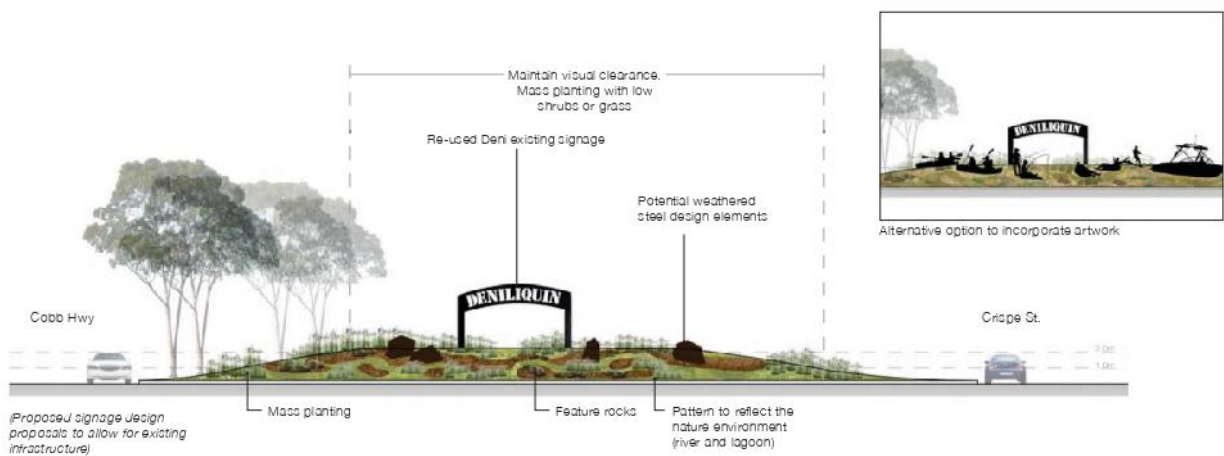

People



Existing town entrance signage



Deni themes (Rice, Wheat, Uts, Water activities, Merino wool and people) to be determined at detailed design.

